

DO NOT SCALE THIS DRAWING USE DIMENSIONS ONLY  
 VERIFY ALL DIMENSIONS ON SITE BEFORE COMMENCING ANY WORK OR SHOP DRAWINGS  
 INFORM THE ARCHITECT BEFORE ANY WORK STARTS IF THIS DRAWING EXCEEDS THE QUANTITIES IN ANY WAY

Revision	Date
A	Oct 14 Plans revised following feedback
B	Nov 14 Plans revised following feedback
C	Dec 14 Plans revised following feedback
D	Feb 15 Colours used on plan updated. Lobby added to the North Door. Electronic Organ relocated

## PROPOSED GROUND FLOOR PLAN - OPTION D

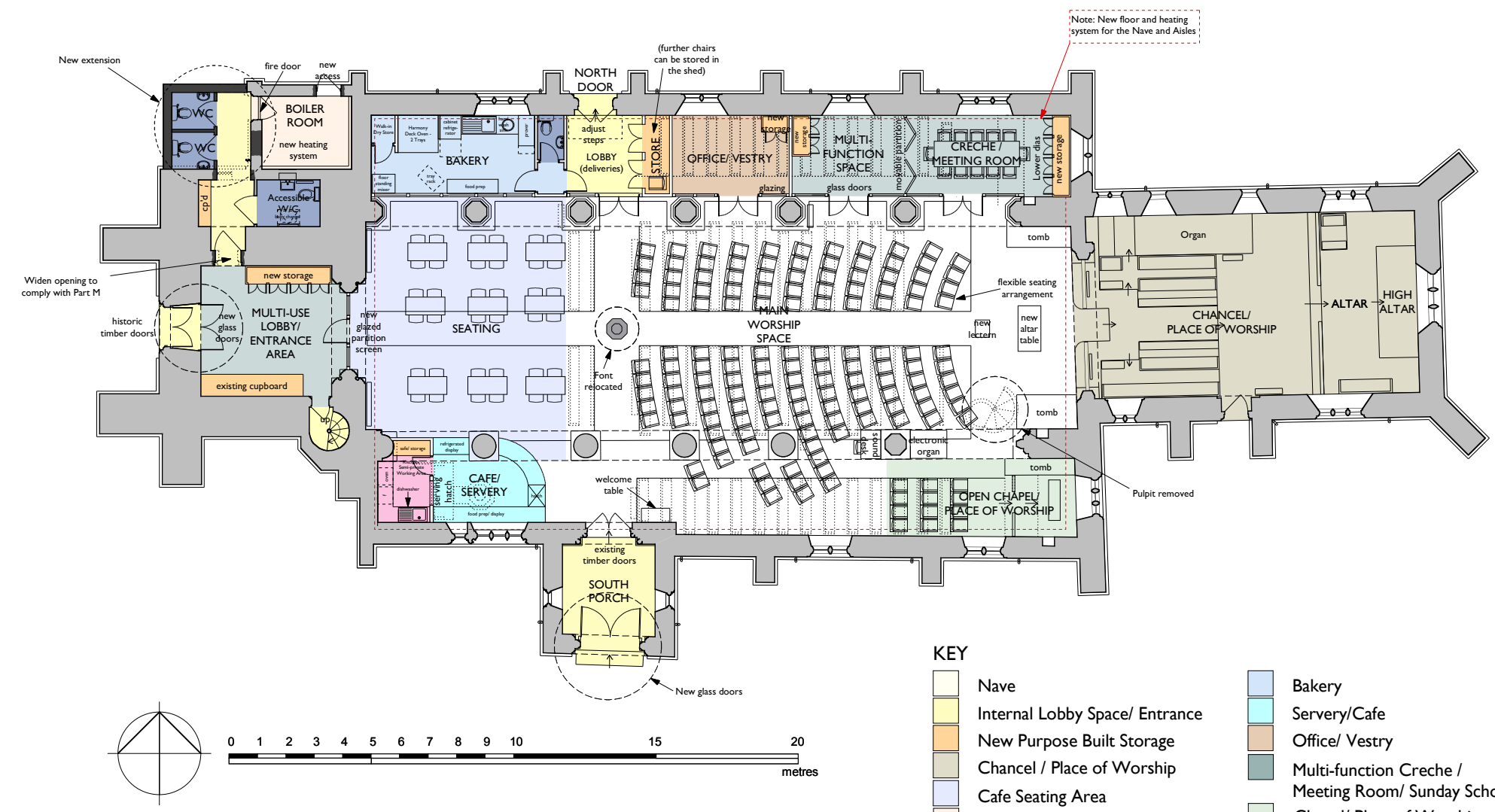

- KEY**
- Nave
  - Internal Lobby Space/ Entrance
  - New Purpose Built Storage
  - Chancel / Place of Worship
  - Cafe Seating Area
  - Boiler House
  - WC's
  - New Masonry
  - Bakery
  - Servery/Cafe
  - Office/ Vestry
  - Multi-function Creche / Meeting Room/ Sunday School
  - Chapel/ Place of Worship
  - Kitchen

DRAWING ISSUE STATUS	REVISION N°	DATE	SIGNED
RISK ASSESSMENT UNDERTAKEN			
PLANNING APPLICATION N° 1			
PLANNING APPLICATION N° 2			
PLANNING CONSENT			
LISTED BLDG APPLICATION			
LISTED BLDG CONSENT			
DAC APPROVAL			
BLDG CONTROL APPLICATION			
BLDG CONTROL APPROVAL			
TENDER DOCUMENT			
CONTRACT DOCUMENT			

CLIENT  
Incumbent and Church Wardens

PROJECT  
St Michael and All Angels Church, Waddesdon

TITLE  
Proposed Ground Floor Plan Option D



**Acanthus Clews**  
architects

SCALE 1:100@A1 1:200@A3	DRAWN JP/JM	Acanthus House 57 Hightown Road Banbury · Oxfordshire OX16 9BE
DATE Feb 2015	DRAWING N° 13_129	Tel: 01295 702600 Fax: 01295 702601
JOB N° 13_129		architects@acanthusclews.co.uk www.acanthusclews.co.uk